

Ozempic® semaglutide

OzempicCare® is a free support program. To find out more go to:

ozempicare.com.au

The Patient Support Program is not authorised or approved by the Australian regulator of medicines, the TGA

0.25 mg, 0.5 mg/dose

Ozempic®, OzempicCare® and NovoFine® are registered trademarks of Novo Nordisk A/S.

Jardiance® is a registered trademark of Boehringer Ingelheim International GmbH.

© 2024

Novo Nordisk A/S

Ozempic®

semaglutide 0.25 mg or 0.5 mg/dose solution for injection pre-filled pen (3mL, 0.68mg/mL)

INSTRUCTIONS FOR USE

Please read these instructions carefully before using your Ozempic® pre-filled pen.

Talk to your doctor, nurse or pharmacist about how to inject Ozempic® correctly.

Start by checking your pen to **make sure that it contains Ozempic® 0.25 mg, 0.5 mg/dose**, then look at the illustrations below to get to know the different parts of your pen and needle.

Ozempic® pre-filled pen and needle (example)

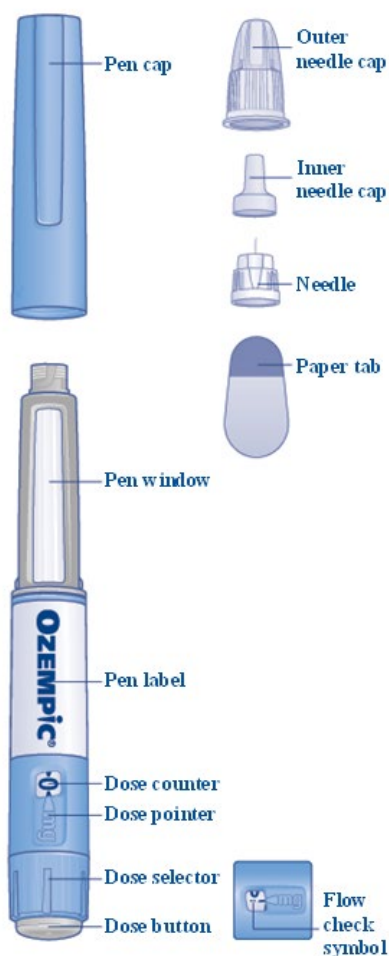

If you are blind or have poor eyesight and cannot read the dose counter on the pen, do not use this pen without help. Get help from a person with good eyesight who knows how to use the Ozempic® pre-filled pen.

Your pen is a pre-filled dial-a-dose pen. It contains 2 mg of semaglutide, and you can select doses of 0.25 mg or 0.5 mg.

One unused pen contains:

- 4 doses of 0.25 mg (starting dose) *and* 2 doses of 0.5 mg
- **or** 4 doses of 0.5 mg

Use the table on the side of the carton to keep track of how many injections you have taken and when you took the injections.

Your pen is designed to be used with NovoFine® disposable needles up to a length of 8 mm.

NovoFine® disposable needles may either be included with your pen or supplied separately.

Important information

Pay special attention to these notes, as they are important for safe use of the pen.

1. Prepare your pen with a new needle

Check the name and coloured label of your pen to make sure that it contains Ozempic® 0.25 mg, 0.5 mg/dose. This is especially important if you take more than one type of injectable medicine. Using the wrong medicine could be harmful to your health.

Pull off the pen cap.

Check that the solution in your pen is clear and colourless. Look through the pen window. If the solution looks cloudy or coloured, do not use the pen.

Take a new needle. Check the paper tab and the outer needle cap for damages that could affect sterility. If any damage is seen, use a new needle.

Tear off the paper tab.

Make sure to attach the needle correctly.

Push the needle straight onto the pen. Turn until it is on tight.

The needle is covered by two caps. You must remove both caps. If you forget to remove both caps, you will **not** inject any solution.

Pull off the outer needle cap and keep it for later. You will need it after the injection, to safely remove the needle from the pen.

Pull off the inner needle cap and throw it away. If you try to put it back on, you may accidentally stick yourself with the needle.

A drop of solution may appear at the needle tip. This is normal, but you must still check the flow, if you use a new pen for the first time. See step 2 'Check the flow with each new pen'.

Do not attach a new needle to your pen until you are ready to take your injection.

 **Always use a new needle for each injection.**

This may prevent blocked needles, contamination, infection and inaccurate dosing.

 **Never use a bent or damaged needle.**

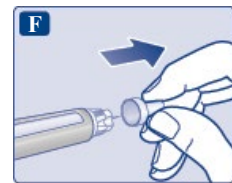
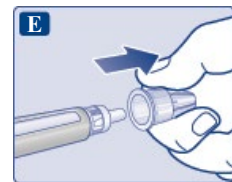
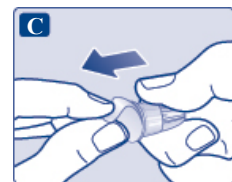
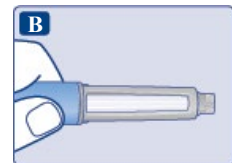
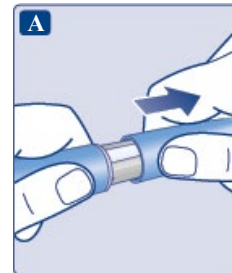

2. Check the flow with each new pen

If your pen is already in use, go to step 3 'Select your dose'. **Only check the flow before your first injection with each new pen.**

Turn the dose selector to the **flow check symbol**

() right past '0'. Make sure the flow check symbol lines up with the pointer.

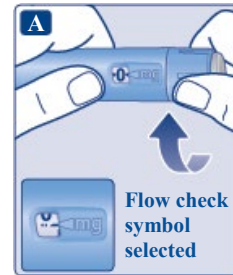

Hold the pen with the needle pointing up. **Press and hold in the dose button** until the dose counter returns to '0.' The '0' must line up with the dose pointer.

A drop of solution should appear at the needle tip.

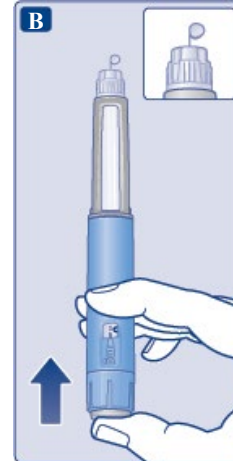

A small drop may remain at the needle tip, but it will not be injected.

If no drop appears, repeat step 2 'Check the flow with each new pen' up to 6 times. If there is still no drop, change the needle and repeat step 2 'Check the flow with each new pen' once more.

Dispose of the pen and use a new one if a drop of solution still does not appear.

⚠ Always make sure that a drop appears at the needle tip before you use a new pen for the first time. This makes sure that the solution flows.

If no drop appears, you will **not** inject any medicine even though the dose counter may move. **This may indicate a blocked or damaged needle.**

If you do not check the flow before your first injection with each new pen, you may not get the prescribed dose and the intended effect of Ozempic®.

3. Select your dose

Turn the dose selector until the dose counter shows your prescribed dose (0.25 mg or 0.5 mg).

If you select the wrong dose, you can turn the dose selector forwards or backwards to the correct dose.

The pen can dial up to a maximum of 0.5 mg.

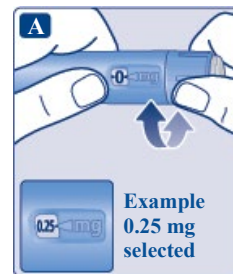

The dose selector changes the dose. Only the dose counter and dose pointer will show how many mg you select per dose.

You can select up to 0.5 mg per dose. When your pen contains less than 0.5 mg, the dose counter stops before 0.5 mg is shown.

The dose selector clicks differently when turned forwards, backwards or past the number of mg left. Do not count the pen clicks.

⚠ Always use the dose counter and the dose pointer to see how many mg you have selected before injecting this medicine.

Do not count the pen clicks.

Only doses of 0.25 mg or 0.5 mg must be selected with the dose selector. The selected dose must line up precisely with the dose pointer to ensure that you get a correct dose.

How much solution is left

To see how much solution is left, use the dose counter: Turn the dose selector until the **dose counter stops**.

If it shows 0.5, **at least 0.5 mg** is left in your pen.

If the **dose counter stops before 0.5 mg**, there is not enough solution left for a full dose of 0.5 mg.

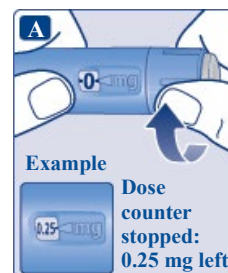

⚠ If there is not enough solution left in your pen for a full dose, do not use it. Use a new Ozempic[®] pen.

4. Inject your dose

Insert the needle into your skin as your doctor or nurse has shown you.

Make sure you can see the dose counter.

Do not cover it with your fingers. This could interrupt the injection.

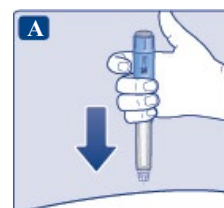

Press and hold down the dose button. Watch as the dose counter returns to '0.'

The '0' must line up with the dose pointer.

You may then hear or feel a click.

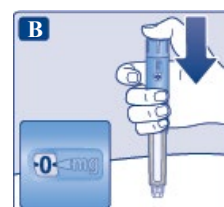

Continue pressing the dose button while keeping the needle in your skin.

Count slowly to 6, while keeping the dose button pressed.

If the needle is removed earlier, you may see a stream of solution coming from the needle tip. If so, the full dose will not be delivered.

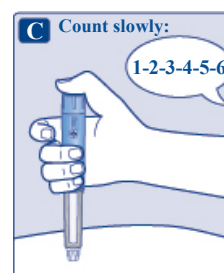

Remove the needle from your skin. You can then release the dose button. If blood appears at the injection site, press lightly.

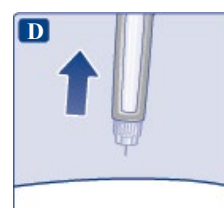

You may see a drop of solution at the needle tip after injecting. This is normal and does not affect your dose.

⚠ Always watch the dose counter to know how many mg you inject. Hold the dose button down until the dose counter returns to '0.'

How to identify a blocked or damaged needle

- If '0' does not appear in the dose counter after continuously pressing the dose button, you may have used a blocked or damaged needle.
- In this case, you have **not** received any medicine – even though the dose counter has moved from the original dose that you have set.

How to handle a blocked needle

Change the needle as described in step 5 'After your injection' and repeat all steps starting with step 1 'Prepare your pen with a new needle'. Make sure that you select the full dose you need.

Never touch the dose counter when you inject. This can interrupt the injection.

5. After your injection

Always dispose of the needle after each injection to ensure convenient injections and prevent blocked needles. If the needle is blocked, you will **not** inject any medicine.

Lead the needle tip into the outer needle cap on a flat surface without touching the needle or the outer needle cap.

Once the needle is covered, **carefully push the outer needle cap completely on.**

Unscrew the needle and dispose of it carefully as instructed by your doctor, nurse or pharmacist.

Put the pen cap on your pen after each use to protect the solution from light.

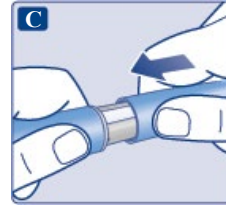
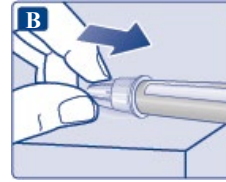
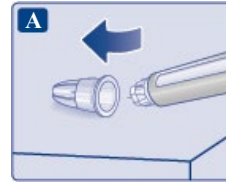

When the pen is empty, throw it away **without** a needle on as instructed by your doctor, nurse or pharmacist.

⚠ Never try to put the inner needle cap back on the needle. You may stick yourself with the needle.

⚠ Always remove the needle from your pen immediately after each injection.

This may prevent blocked needles, contamination, infection, leakage of solution and inaccurate dosing.

⚠ Further important information

- Always keep your pen and needles **out of the sight and reach of others**, especially children.
- **Never share your pen or your needles** with other people.
- Caregivers must **be very careful when handling used needles** to prevent needle injury and cross-infection.

Caring for your pen

Treat your pen with care. Rough handling or misuse may cause inaccurate dosing. If this happens you might not get the intended effect of this medicine.

- **Do not leave the pen in a car** or another place where it can get too hot or too cold.
- **Do not inject Ozempic® which has been frozen.** If you do that, you might not get the intended effect of this medicine.
- **Do not inject Ozempic® which has been exposed to direct sunlight.** If you do that, you might not get the intended effect of this medicine.
- **Do not expose your pen to dust, dirt or liquid.**
- **Do not wash, soak or lubricate your pen.** It may be cleaned with a mild detergent on a moistened cloth.
- **Do not drop your pen** or knock it against hard surfaces. If you drop it or suspect a problem, attach a new needle and check the flow before you inject.
- **Do not try to refill your pen.** Once empty, it must be disposed of.
- **Do not try to repair your pen** or pull it apart.