

Instructions for Use

BRETARIS® GENUAIR®

This leaflet contains information on how to use your BRETARIS GENUAIR inhaler. It is important that you read this information as the BRETARIS GENUAIR inhaler may work differently from inhalers you have used previously. If you have any questions about how to use your inhaler, please ask your doctor, pharmacist or nurse for assistance.

This instructions for use leaflet is divided into sections:

- Getting started
- Step 1: Prepare your dose
- Step 2: Inhale your dose
- Additional Information

Getting Started

Before using the BRETARIS GENUAIR inhaler, please read the full instructions.

You should become familiar with the parts of your inhaler (see image 1).

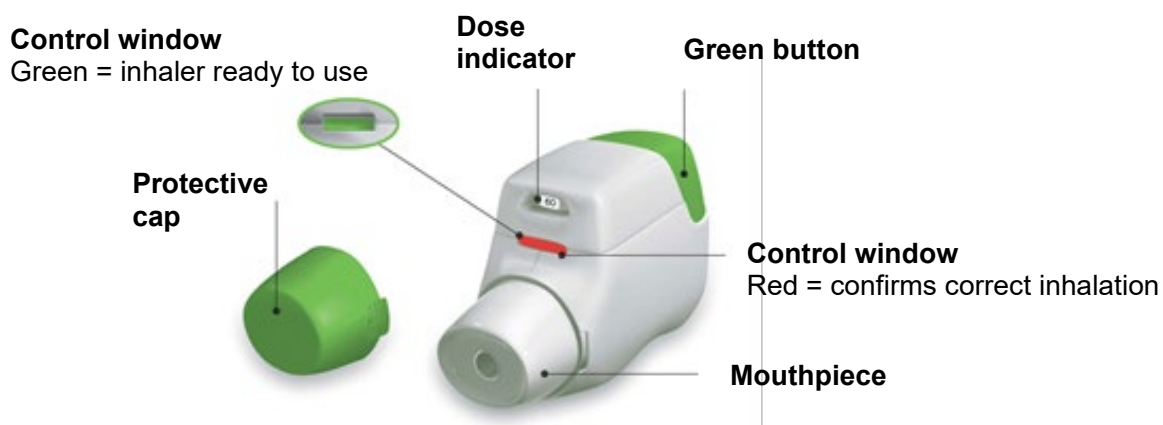

IMAGE 1

Before Use

- Before first use, tear the sealed pouch along the notch and remove the inhaler.
- Do not press the green button until you are ready to take a dose.
- When you are about to take your dose of medicine, remove the protective cap by **lightly squeezing the arrows** marked on each side and pulling outwards (see image 2).

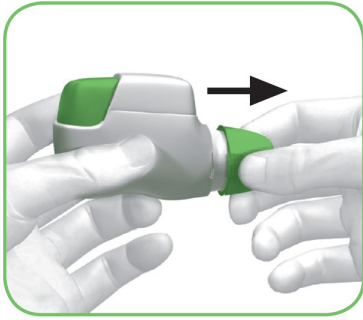

IMAGE 2

Step 1: Activate Your Inhaler

- 1.1 Look to see that nothing is blocking the mouthpiece (see image 3).
- 1.2 Look at the coloured control window and it should be red (see image 3).

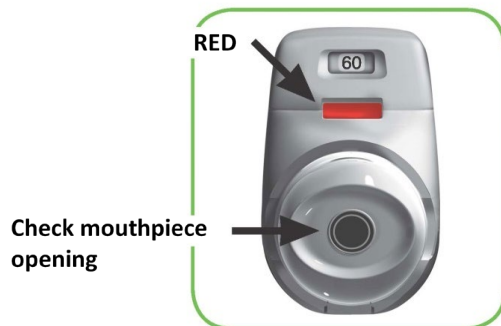

IMAGE 3

- 1.3 Hold the inhaler horizontally with the mouthpiece towards you and the green button facing straight up (see image 4).

Make sure the green button is on top. **Do not tilt.**



IMAGE 4

- 1.4 Press the green button all the way down to load your dose (see image 5). When you press the button all the way down, the control window changes from red to green.
- 1.5 Release the green button (see image 6).

Make sure you release the green button so the inhaler can work correctly.

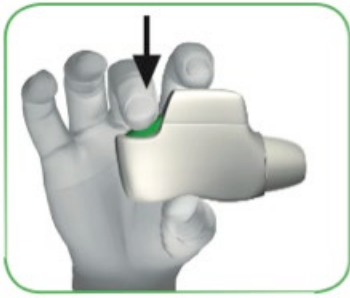

IMAGE 5



IMAGE 6

Stop and Check: Make sure your dose is ready for inhalation

1.6 Make sure the coloured control window has changed to **green** (see image 7).

- The green control window confirms that your medicine is ready for inhalation.

IF THE COLOURED CONTROL WINDOW STAYS RED AFTER PRESSING THE GREEN BUTTON ALL THE WAY DOWN, GO BACK TO 'STEP 1 ACTIVATE YOUR INHALER' AND REPEAT STEPS 1.1 TO 1.6.



IMAGE 7

Step 2: Inhale your dose

Read steps 2.1 to 2.7 fully before use. **Do not hold the green button down while inhaling.** Do not tilt.

- 2.1 Before bringing the inhaler to your mouth, breathe out completely away from the mouthpiece. Do not breathe out into the mouthpiece of the inhaler.
- 2.2 Hold your head upright and close your lips tightly around the mouthpiece of the inhaler.
- 2.3 Breathe in **STRONGLY** and **DEEPLY** through your mouth (see image 8). This strong, deep breath pulls the medicine through the inhaler into your lungs.

While you breathe in you will hear a “**CLICK**” which signals that you are inhaling correctly. Keep breathing in for as long as possible even after you have heard the “**CLICK**” to be sure you get the full dose.

ATTENTION: DO NOT HOLD THE GREEN BUTTON DOWN WHILE YOU ARE INHALING. DO NOT TILT.

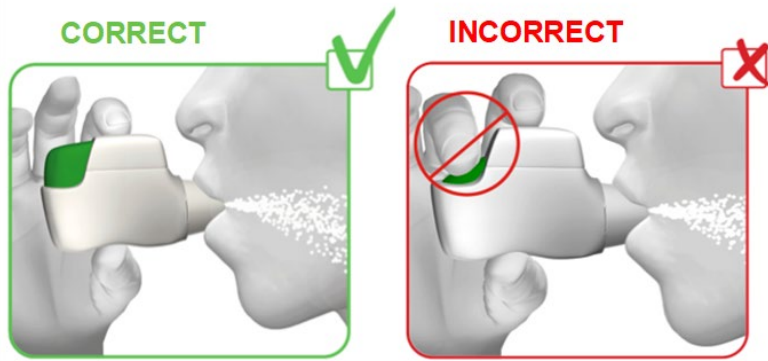

IMAGE 8

2.4 Remove the inhaler from your mouth.

2.5 Hold your breath for as long as is comfortable.

2.6 Breathe out slowly through your nose, away from the mouthpiece.

Some patients may experience a grainy sensation in their mouth, or a slightly sweet or bitter taste when inhaling the medicine. Do not take an extra dose if you do not taste or feel anything after inhaling.

Stop and check: Make sure you have inhaled correctly

2.7 Make sure the control window is now **red** (see image 9). This confirms that you have inhaled your full dose correctly.

IF THE COLOURED CONTROL WINDOW IS STILL GREEN, THIS MEANS YOU HAVE NOT INHALED YOUR FULL DOSE CORRECTLY. GO BACK TO 'STEP 2 INHALE YOUR DOSE' AND REPEAT STEPS 2.1 TO 2.7.

- If the control window still does not change to **red**, you may have forgotten to release the green button before inhaling or may not have inhaled correctly. If that happens, try again.

Make sure you have RELEASED the green button and take a STRONG DEEP breath in through the mouthpiece.

Note: If you are unable to inhale correctly after several attempts, consult your doctor.

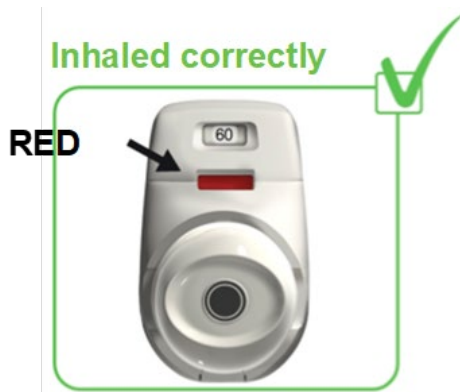

IMAGE 9

- Once the control window has turned red, replace the protective cap by pressing it back onto the mouthpiece (see image 10). This will prevent moisture from getting inside the mouthpiece of your inhaler.

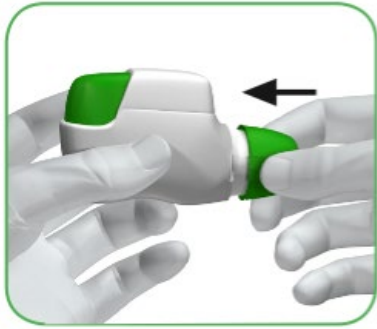

IMAGE 10

Additional information

What should you do if you accidentally prepared a dose?

Store your inhaler with the protective cap in place until it is time to inhale your dose, then remove the cap and start at Step 1.6.

How should you clean the inhaler?

You DO NOT NEED to clean your inhaler. However, if you wish to clean it you should do so by wiping the outside of the mouthpiece with a dry tissue or paper towel.

NEVER use water to clean the inhaler, as this may damage your medicine.

How does the dose indicator work?

- The inhaler is equipped with a dose indicator to show you approximately how many doses are left in the inhaler.
- On first use, every inhaler contains at least 60 doses, or at least 30 doses, depending on the pack size.
- Each time you load a dose by pressing the green button all the way down, the dose indicator moves down slowly displaying intervals of 10 (60, 50, 40, 30, 20, 10, 0) (see image 11).

Dose indicator goes down by intervals of 10: 60, 50, 40, 30, 20, 10, 0.



IMAGE 11

When should you get a new inhaler?

You should get a new inhaler:

- When a **red striped band** appears in the dose indicator (see image 11); this means you are nearing your last dose, or
- If your inhaler appears to be damaged or if you lose the cap, or
- If your inhaler is empty (see '**How do you know that your inhaler is empty?**').

How do you know that your inhaler is empty?

- When 0 (zero) appears in the middle of the dose indicator, you should continue using any doses remaining in the inhaler.
- When the last dose has been prepared for inhalation, the green button will not return to its full upper position, but will be locked in a middle position (see image 12). Even though the green button is locked, your last dose may still be inhaled. After that, the inhaler cannot be used again and you should start using a new BRETARIS GENUAIR inhaler.



IMAGE 12

--

BRETARIS GENUAIR is supplied in Australia by:

A. Menarini Australia Pty Ltd
Sydney, Australia

Tel: 1800 644 542

BRETARIS® is a registered trademark of Almirall, S.A.

GENUAIR® is a registered trademark of AstraZeneca AB

This leaflet was prepared in February 2025.

AUST R 206071

Version No.4