

# LUMIGAN® PF EYE DROPS

---

## Consumer Medicine Information (CMI) summary

The [full CMI](#) on the next page has more details. If you are worried about using this medicine, speak to your doctor or pharmacist.

---

### 1. Why am I using LUMIGAN® PF eye drops?

LUMIGAN® PF eye drops contains the active ingredient bimatoprost. LUMIGAN® PF eye drops is used to lower raised pressure in the eye and to treat glaucoma.

For more information, see Section [1. Why am I using LUMIGAN® PF eye drops?](#) in the full CMI.

### 2. What should I know before I use LUMIGAN® PF eye drops?

Check the list of ingredients at the end of the CMI. Do not use LUMIGAN® PF eye drops if you have ever had an allergic reaction to any of them.

**Talk to your doctor before you use this medicine if he/she is not aware that you have any other medical conditions, take any other medicines, or**

are pregnant or plan to become pregnant or are breastfeeding.

For more information, see Section [2. What should I know before I use LUMIGAN® PF eye drops?](#) in the full CMI.

### 3. What if I am taking other medicines?

Some medicines may interfere with LUMIGAN® PF eye drops and affect how it works, or LUMIGAN® PF eye drops may interfere with other medicines and affect how they work.

A list of these medicines is in Section [3. What if I am taking other medicines?](#) in the full CMI.

### 4. How do I use LUMIGAN® PF eye drops?

- Use one drop in your affected eye(s), according to your doctor's instructions
- Use the drops each evening.

More instructions can be found in Section [4. How do I use LUMIGAN® PF eye drops?](#) in the full CMI.

### 5. What should I know while using LUMIGAN® PF eye drops?

<b>Things you should do</b>	<ul style="list-style-type: none"><li>• Remind any doctor, dentist, pharmacist, or optometrist you</li></ul>
-----------------------------	--

	<p>visit that you are using LUMIGAN® PF eye drops</p> <ul style="list-style-type: none"> <li>• Continue to use LUMIGAN® PF eye drops every evening unless your doctor tells you to stop</li> <li>• Keep all your appointments so your condition can be checked.</li> </ul>
<p><b>Things you should not do</b></p>	<ul style="list-style-type: none"> <li>• Do not touch the dropper tip against your eye, eye lid or any surface</li> <li>• Do not stop using LUMIGAN® PF eye drops without checking with your doctor</li> <li>• Do not use LUMIGAN® PF eye drops while you are wearing contact lenses.</li> </ul>
<p><b>Driving or using machines</b></p>	<ul style="list-style-type: none"> <li>• Wait until your vision clears after using LUMIGAN® PF eye drops before driving or using machines.</li> </ul>

<b>Drinking alcohol</b>	<ul style="list-style-type: none"> <li>• There is no information on the effects of using LUMIGAN® PF eye drops with alcohol.</li> </ul>
<b>Looking after your medicine</b>	<ul style="list-style-type: none"> <li>• Follow all instructions on the carton and label</li> <li>• Store it in a cool dry place, below 25°C, away from moisture, heat, or sunlight.</li> </ul>

For more information, see Section [5. What should I know while using LUMIGAN® PF eye drops?](#) in the full CMI.

## **6. Are there any side effects?**

The most common side effects include red, congested eyes, growth of eyelashes, itching or irritation of the eye. Note that side effects can occur in other parts of the body, including serious allergic reaction (anaphylaxis).

For more information, including what to do if you have any side effects, see Section [6. Are there any side effects?](#) in the full CMI.

# LUMIGAN® PF EYE DROPS (loom-ig-gan)

**Active ingredient:** *bimatoprost* (bim-at-oh-prost)

---

## Consumer Medicine Information (CMI)

This leaflet provides important information about using LUMIGAN® PF eye drops. **You should also speak to your doctor or pharmacist if you would like further information or if you have any concerns or questions about using LUMIGAN® PF eye drops.**

**Where to find information in this leaflet:**

- [1. Why am I using LUMIGAN® PF eye drops?](#)
- [2. What should I know before I use LUMIGAN® PF eye drops?](#)
- [3. What if I am taking other medicines?](#)
- [4. How do I use LUMIGAN® PF eye drops?](#)
- [5. What should I know while using LUMIGAN® PF eye drops?](#)
- [6. Are there any side effects?](#)
- [7. Product details](#)

## 1. Why am I using LUMIGAN® PF eye drops?

**LUMIGAN® PF eye drops contains the active ingredient bimatoprost.**

**LUMIGAN® PF eye drops is used to lower raised pressure in the eye and to treat glaucoma.**

Glaucoma is a condition in which the pressure of fluid in the eye may be high. However, some people with glaucoma may have normal eye pressure. Glaucoma is usually caused by a build up of the fluid which flows through the eye. This build up occurs because the fluid drains out of your eye more slowly than it is being pumped in. Since new fluid continues to enter the eye, joining the fluid already there, the pressure continues to rise. This raised pressure may damage the back of the eye resulting in gradual loss of sight. Damage can progress so slowly that the person is not aware of this gradual loss of sight. Sometimes even normal eye pressure is associated with damage to the back of the eye.

There are usually no symptoms of glaucoma. The only way of knowing that you have glaucoma is to have your eye pressure, optic nerve, and visual field checked by an eye specialist or optometrist. If glaucoma is not treated it can lead to serious problems, including total blindness. In fact, untreated glaucoma is one of the most common causes of blindness.

LUMIGAN® PF eye drops lower the pressure in the eye by helping the flow of fluid out of the eye chamber.

LUMIGAN® PF eye drops can be used alone or together with other eyedrops/medicines to lower raised pressure within your eyes.

Although LUMIGAN® PF eye drops help control your condition, they will not cure it.

Your doctor may have prescribed this medication for another reason. Ask your doctor if you have any questions about why LUMIGAN®PF eye drops have been prescribed for you.

## **2. What should I know before I use LUMIGAN® PF eye drops?**

### **Warnings**

#### **Do not use LUMIGAN® PF eye drops if:**

- you are allergic to bimatoprost, or any of the ingredients listed at the end of this leaflet.
- The vial is broken, the packaging shows signs of tampering, or the product does not look quite right.

#### **Check with your doctor if:**

- you have or have had inflammation in the eye, such as uveitis
- you have had eye surgery
- your eye does not have a lens
- your eye has an artificial lens, following cataract surgery
- the capsule ("bag") that normally holds the eye's lens in place is torn, or ruptured

- you have had other problems with your eyes, such as inflammation or swelling of the light sensitive part of the eye known as the macula, a diabetes-related eye condition
- you have a diabetes-related eye condition, such as diabetic retinopathy or blockage of a retinal vein
- you have or have had low blood pressure or a slow heartbeat
- you have or have had problems with your lungs or airways
- you have or have had problems with your liver or kidneys
- you take any medicines for any other condition.
- you have had an allergy to any medicines or any other substances, such as foods, preservatives or dyes

During treatment, you may be at risk of developing certain side effects. It is important you understand these risks and how to monitor for them. See additional information under Section [6. Are there any side effects?](#)

It is not known if LUMIGAN® PF eye drops are safe and useful for children and adolescents under 18 years.

## **Pregnancy and breastfeeding**

Make sure your doctor is aware that you are pregnant or plan to become pregnant or are breastfeeding or intend to breastfeed.



## **Cosmetic effects**

Before you start using LUMIGAN® PF eye drops your doctor should tell you that some changes to your eyes may occur which may be permanent.

During treatment, LUMIGAN® PF may cause a loss of fat around the eye, which may cause your eyelid crease to deepen, your eye to appear sunken, your upper eyelid to droop, the skin around your eye to tighten and the lower white part of your eye to become more visible. The changes are typically mild, but if pronounced, they can affect your field of vision. The changes may disappear if you stop taking LUMIGAN® PF.

Eyelashes may also grow longer and thicker, and eyelashes, the skin around the eye and the coloured part of the eye (iris) may become darker. If only one eye is being treated the cosmetic differences between the eyes may be noticeable. None of these changes affect vision. If you have any concerns, ask your doctor or pharmacist.

Hair may grow where LUMIGAN® PF contacts the skin. It is important to use as directed.

### **3. What if I am taking other medicines?**

Tell your doctor or pharmacist if you are taking any other medicines, including any medicines, vitamins or supplements that you buy without a prescription from your pharmacy, supermarket or health food shop.

**Some medicines may interfere with LUMIGAN® PF eye drops and affect how it works; while LUMIGAN® PF eye drops may affect how other medicines work.**

**Medicines that may reduce the effect of LUMIGAN® PF eye drops and where LUMIGAN® PF eye drops may reduce their effect include:**

- other eye drops in the same class as LUMIGAN® PF eye drops, such as latanoprost, tafluprost, and travoprost.

**Check with your doctor or pharmacist if you are not sure about what medicines, vitamins or supplements you are taking and if these affect LUMIGAN® PF eye drops.**

## **4. How do I use LUMIGAN® PF eye drops?**

Follow all directions given to you by your doctor carefully. The directions may differ from the information contained in this leaflet.

### **How much to use**

- Your doctor will tell you how many drops you need to use each day. Use LUMIGAN® PF eye drops only as prescribed by your doctor.
- The usual dose of LUMIGAN® PF eye drops is one drop in your affected eye(s), according to your doctor's instructions.

## **When to use LUMIGAN® PF eye drops**

- Use the drops each evening.

Use LUMIGAN® PF eye drops every day, at about the same time each day, unless your doctor tells you otherwise. Using your eye drops at the same time each day will have the best effect on your eye pressure. It will also help you remember when to use the eye drops.

In some instances, LUMIGAN® PF eye drops needs to be used with other eye drops. Your doctor will let you know which drops, how to use them, and how long to use them.

If you are using more than one eye drop product, wait 5 minutes before using the second product. If you are also using an eye ointment, instill the eye ointment last.

If you are being changed from one eye drop to another, follow your doctor's instructions carefully as to when to stop the old drops and when to start the new drops.

## **How to use LUMIGAN® PF eye drops**

These drops are for use in your eyes only.

You may find it easier to put drops in your eye while you are sitting or lying down.

If you are wearing soft contact lenses, remove them before putting the drops in your eye.

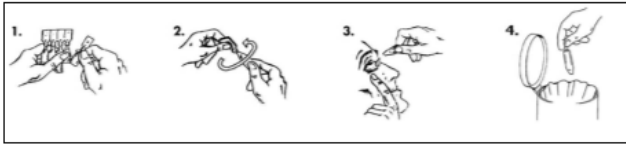

Make sure that the ampoule is intact before use.

The solution should be used immediately after opening.

1. Wash your hands well with soap and water before use
2. Tear 1 ampoule from the strip.
3. Hold the ampoule upright (with the cap pointing upwards) and twist off the cap.
4. Gently pull down the lower eyelid to form a pocket. Turn the ampoule upside down and squeeze it to release 1 drop into the affected eye(s).
5. While your eye is closed, place your index finger against the inside corner of your eye and press against your nose for about two minutes. This will help to stop the medicine from draining through the tear duct to the nose and throat, from where it can be absorbed into other parts of your body. Ask your doctor for more specific instructions on this technique.
6. Throw away the ampoule after you have used it, even if there is some solution left.
7. Wash your hands again with soap and water to remove any residue.

Wait 15 minutes before replacing your contact lenses.

If a drop misses your eye, try again. Wipe off any excess that runs down the cheek.

Be careful not to touch the dropper tip against your eye, eyelid or anything else to avoid injury and contaminating the eye drops.

### **If you forget to use LUMIGAN® PF eye drops**

It is important that you use LUMIGAN® PF eye drops at the same time each evening.

**If you forget to use LUMIGAN® PF eye drops and it is almost time for your next dose,** use your drops at the usual time the next evening.

**If you miss your dose and remember through the night or in the morning,** use the drops as soon as you remember and go back to using them at your usual time.

If you are not sure whether to skip the dose, talk to your doctor or pharmacist.

**Do not use double the number of drops to make up for the dose you missed.**

### **If you use too much LUMIGAN® PF eye drops**

Immediately rinse your eyes with warm water.

### **If LUMIGAN® PF eye drops is accidentally swallowed**

**You should immediately:**

- phone the Poisons Information Centre (by calling **13 11 26** in Australia or **0800 POISON (0800 764 766)** in New Zealand), or

- contact your doctor, or
- go to the Emergency Department at your nearest hospital.

**You should do this even if there appear to be no signs of discomfort or poisoning.**

## **5. What should I know while using LUMIGAN® PF eye drops?**

### **Things you should do**

- Continue to use LUMIGAN® PF eye drops every evening unless your doctor tells you to stop. LUMIGAN® PF eye drops helps to control your condition but does not cure it.
- Use all the medication prescribed to treat your eye condition.
- Keep all your doctor's appointments so that your condition can be monitored, and your eye pressure can be checked.
- Tell your doctor if you think your condition is not improving while using LUMIGAN® PF eye drops.

### **Call your doctor straight away if you:**

- develop any problems with your eye(s), such as, trauma, change of vision, infection in the eye or eyelid, or have eye surgery
- become pregnant while using LUMIGAN® PF eye drops.

Remind any doctor, dentist, pharmacist, or optometrist you visit that you are using LUMIGAN® PF eye drops.

## **Things you should not do**

- Do not touch the dropper tip against your eye, eyelid or anything else, to avoid contaminating the eye drops.
- Do not stop using LUMIGAN® PF eye drops without checking with your doctor. Your eye pressure can rise again and may cause damage to your eye.

## **Driving or using machines**

Your vision may be blurred after using LUMIGAN® PF eye drops. Wait until your vision clears before driving or using machines.

## **Looking after your medicine**

Follow the instructions on the carton and label on how to take care of your medicine properly.

Store it in a cool dry place away from moisture, heat or sunlight; for example:

- do not store it in the bathroom or near a sink, or
- do not store it in the car or on window sills.

**Keep it where young children cannot reach it.**

## **When to discard your medicine**

**For the 30 x 0.4 mL pack, use the ampoules within 30 days after opening the pouch.**

**Each ampoule is intended for a single treatment in the affected eye(s). Discard the ampoule immediately after use.**

## **Getting rid of any unwanted medicine**

If your doctor advises that you no longer need to use this medicine or it is out of date, take it to any pharmacy for safe disposal.

Do not use this medicine after the expiry date has passed.

## **6. Are there any side effects?**

All medicines can have side effects. If you do experience any side effects, most of them are minor and temporary. However, some side effects may need medical attention.

See the information below and, if you need to, ask your doctor or pharmacist if you have any further questions about side effects.

### **Less serious side effects**

<b>Less serious side effects</b>	<b>What to do</b>
<b>Effects on the eye(s):</b> <ul style="list-style-type: none"><li>• red, congested eyes</li><li>• itching or irritation of the eye</li></ul>	<b>Speak to your doctor if you have any of these less serious side effects and they worry you.</b>



<b>Less serious side effects</b>	<b>What to do</b>
<ul style="list-style-type: none"> <li>● small spots on the eye surface</li> <li>● feeling of something in the eye</li> <li>● dry eye</li> <li>● growth of eyelashes</li> <li>● redness in or around eye or eyelid</li> <li>● watery eyes</li> <li>● inflamed eyelids</li> <li>● eye discomfort</li> <li>● eye strain</li> <li>● burning of the eye and nearby eyelid</li> <li>● itchy eye and eyelid</li> <li>● inflammation inside the eye swelling of the surface of the eye</li> <li>● sensitivity to light</li> <li>● darkening of the area around the eye</li> <li>● eyelash darkening</li> <li>● darkening of the coloured part of the eye (iris)</li> <li>● more often, the following effects have been seen: loss of fat in the eye</li> </ul>	

<b>Less serious side effects</b>	<b>What to do</b>
<p>region which can lead to deepening of your eyelid crease, sunken eye, drooping eyelid, tightening of the skin around your eye, and the lower white part of your eye to become more visible.</p> <p><b>Effects on the body as a whole:</b></p> <ul style="list-style-type: none"> <li>● headache</li> <li>● feeling weak and tired</li> <li>● symptoms of a cold such as runny nose or nasal congestion</li> <li>● excessive or abnormal hair growth in areas where the product repeatedly comes into contact with the skin</li> <li>● nausea</li> <li>● dizziness</li> <li>● allergic skin reaction (rash, itching, hives)</li> </ul>	

## Serious side effects

Serious side effects	What to do
<p data-bbox="204 432 692 479"><b>Effects on the eye(s):</b></p> <ul data-bbox="204 510 766 1473" style="list-style-type: none"><li data-bbox="204 510 550 560">● eye discharge</li><li data-bbox="204 577 432 627">● eye pain</li><li data-bbox="204 645 730 757">● small spots on the eye surface</li><li data-bbox="204 775 746 931">● blurred vision or changes in/disturbance of vision</li><li data-bbox="204 949 766 1173">● macular edema (build-up of fluid at the back of the eye, which causes vision to become blurry)</li><li data-bbox="204 1191 699 1473">● spasm of the eyelids where there is uncontrolled blinking and squeezing of the eyelid.</li></ul> <p data-bbox="204 1491 759 1603"><b>Effects on the body as a whole:</b></p> <ul data-bbox="204 1635 753 1881" style="list-style-type: none"><li data-bbox="204 1635 673 1684">● high blood pressure</li><li data-bbox="204 1702 753 1814">● asthma or worsening of asthma</li><li data-bbox="204 1832 635 1881">● difficulty breathing</li></ul>	<p data-bbox="810 432 1375 645"><b>Call your doctor straight away, if you notice any of these serious side effects.</b></p>

<b>Serious side effects</b>	<b>What to do</b>
<ul style="list-style-type: none"> <li>depression (low mood, feelings of worthlessness)</li> </ul>	
<p><b>Effects on the body as a whole:</b></p> <ul style="list-style-type: none"> <li>severe allergic reaction, including swelling of the tongue, lips and throat, difficulty breathing.</li> </ul>	<p><b>Go straight to the Emergency Department at your nearest hospital if you notice any of these serious side effects.</b></p>

**Tell your doctor or pharmacist if you notice anything else that may be making you feel unwell.**

Other side effects not listed here may occur in some people.

## **Reporting side effects**

After you have received medical advice for any side effects you experience, you can report side effects to the Therapeutic Goods Administration online at [www.tga.gov.au/reporting-problems](http://www.tga.gov.au/reporting-problems) in Australia or to <https://nzphvc.otago.ac.nz/reporting/> in New Zealand. By reporting side effects, you can help provide more information on the safety of this medicine.

**Always make sure you speak to your doctor or pharmacist before you decide to stop taking any of your medicines.**

## 7. Product details

This medicine is only available with a doctor's prescription.

### What LUMIGAN® PF eye drops contains

<b>Active ingredient (main ingredient)</b>	<ul style="list-style-type: none"><li>• bimatoprost</li></ul>
<b>Other ingredients (inactive ingredients)</b>	<ul style="list-style-type: none"><li>• citric acid monohydrate</li><li>• dibasic sodium phosphate heptahydrate</li><li>• hydrochloric acid</li><li>• purified water</li><li>• sodium chloride</li><li>• sodium hydroxide</li></ul>

**Do not use this medicine if you are allergic to any of these ingredients.**

### What LUMIGAN® PF eye drops looks like

LUMIGAN® PF eye drops is a clear, colourless solution supplied in single-use plastic ampoules. Each ampoule contains 0.4 mL of liquid. Ampoules are packaged in 5 ampoule and 30 ampoule packs. (AUST R 199469).

- 5 x 0.4 mL ampoules are connected in a strip and packed into a carton.

- 30 x 0.4 mL ampoules. Two of each 5 dose ampoule strips are packed in an aluminium pouch. Three pouches are then packed in a carton.

(Not all presentations may be available).

## **Who distributes LUMIGAN® PF eye drops?**

LUMIGAN® PF eye drops eye drops are distributed in Australia by:

AbbVie Pty Ltd

241 O’Riordan Street

Mascot NSW 2020

Australia

LUMIGAN® PF eye drops eye drops are distributed in New Zealand by:

AbbVie Limited

6th Floor, 156-158 Victoria St

Wellington, 6011

New Zealand

This leaflet was prepared in Aug 2023.

© 2023 AbbVie. All rights reserved.

LUMIGAN and its design are trademarks of Allergan, Inc., an AbbVie company.